



Installing The Profix® Ultra-Low Profile Screed System on a Suspended Timber Floor

All materials must be stored between +5°C and +25°C and allowed to acclimatize to the environment in which they are to be installed (+10°C to +25°C) for a minimum of 24 hours before installation. Materials must not be exposed to direct sunlight.

PREPARE THE TIMBER FLOOR

Ensure the floor is capable of supporting the required loads and that its surface flatness meets the requirements of the chosen final floor covering.

Fill any gaps between floorboards where the Profix® Levelling Compound could escape or over-board the entire floor with 6mm plywood (glued & screwed).

Old coatings, adhesives or other surface contaminants should be removed and the floor vacuumed to remove any dust or debris.



The floor should now be primed using a suitable dispersion primer, diluted in accordance with the product data sheet, and dispersed using a soft brush.

The dispersion primer should become touch dry after approximately 4-6 hours in good drying conditions, after which foot traffic should be kept to a minimum in order to avoid possible contamination of the primed surface.

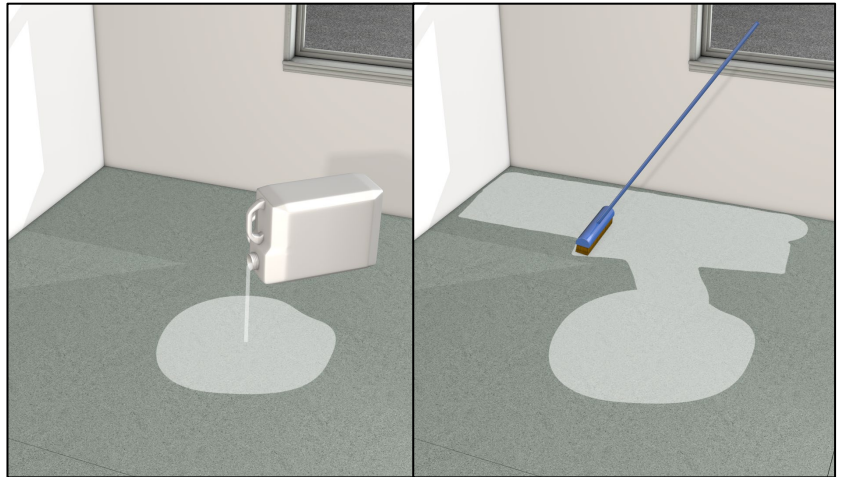

Profix® PE Edge Insulation should now be fitted around the perimeter of each room and to any other vertical upstands.

Peel back the release paper on the 25mm width to expose the adhesive and stick it down to the floor. The 25mm width should form a right-angle with the 50mm width standing vertically up the walls and other upstands.

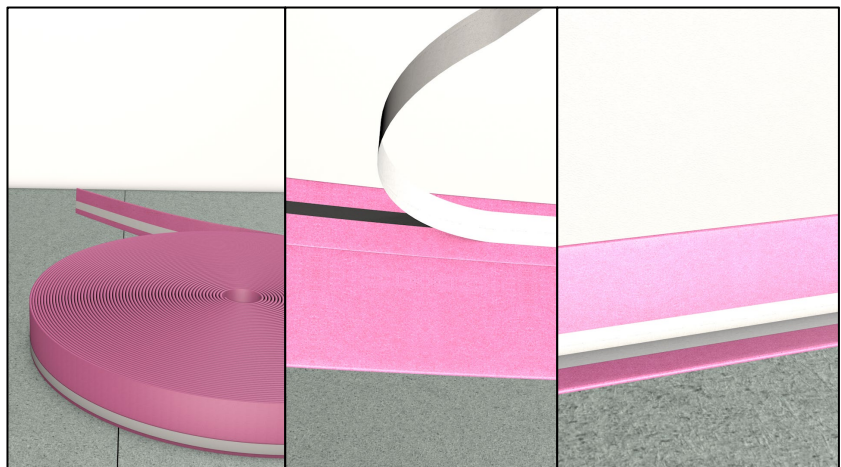

INSTALL THE PROFIX PANELS

Peel off the backing sheet on the first panel to expose the adhesive.

Place the first Profix® Panel in the corner of the room and abut it to the edge of the Profix® PE Edge Insulation, ensuring that the 'arrow heads' of the male snap clips are facing to the LEFT.

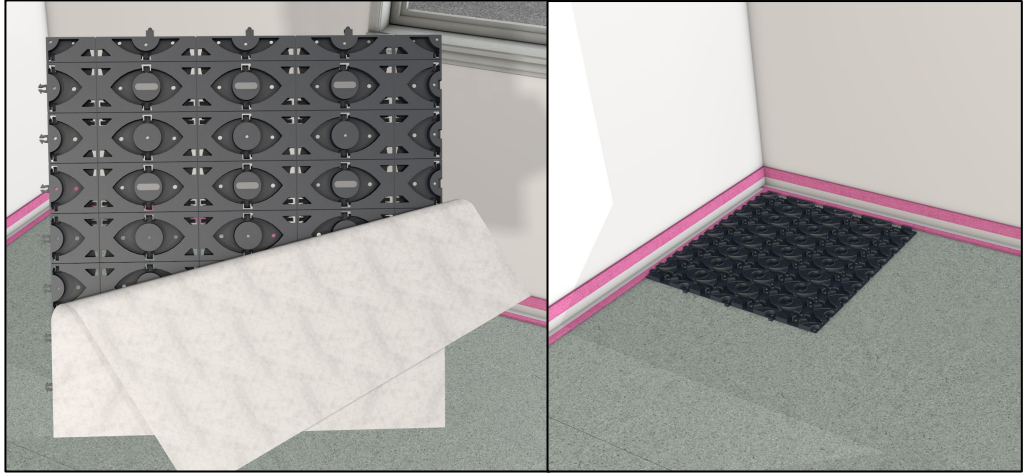

Place the second Profix® Panel with the arrow heads facing to the left and engage them into the gates along the right hand edge of the first panel. Peel off the backing sheet on the second panel to expose the adhesive and stick it down.

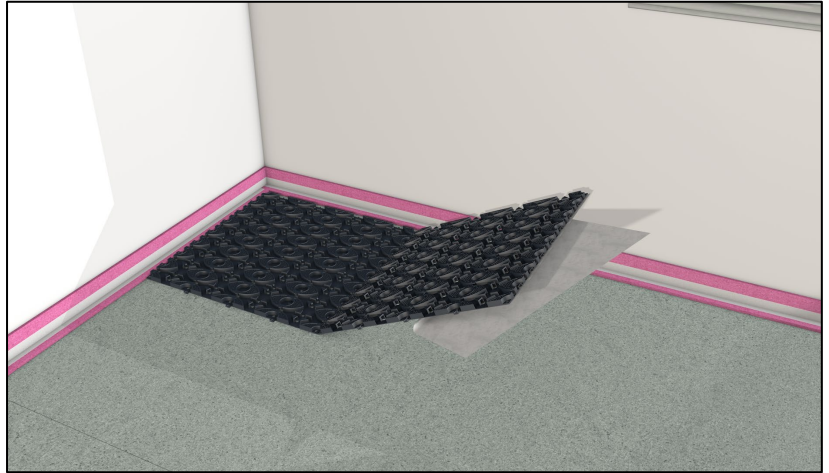

Stick down the panels as before to complete the first row, cutting the final panel in the row to size if required.

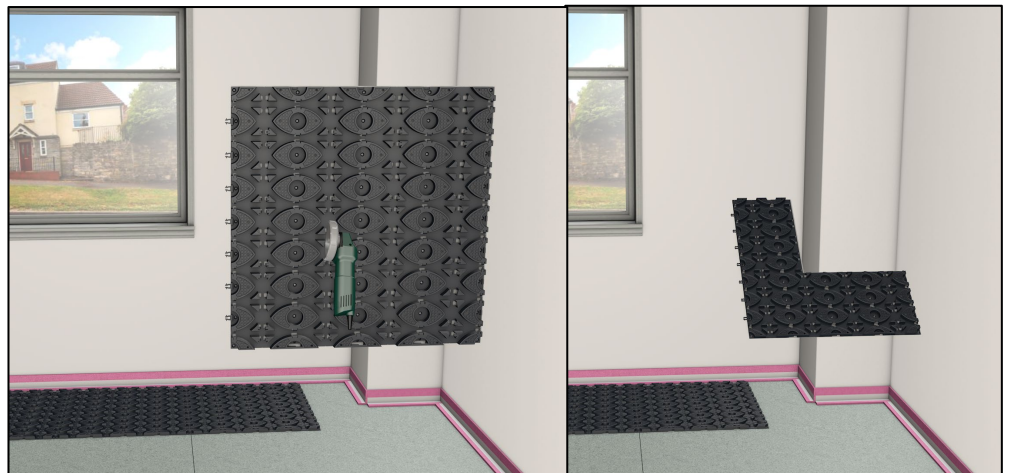

INSTALL THE PROFIX PANELS

Commence laying the second row by positioning the first panel in the second row with the 'arrow heads' facing to the LEFT and ensure that as the panel is hinged down to stick it to the floor the 'fingers' of the adjacent panel in the first row locate into the 'gates' in this panel.

Continue laying the second row of panels until complete, cutting the final panel in the row to size if required.

Continue laying the panels a row at a time.

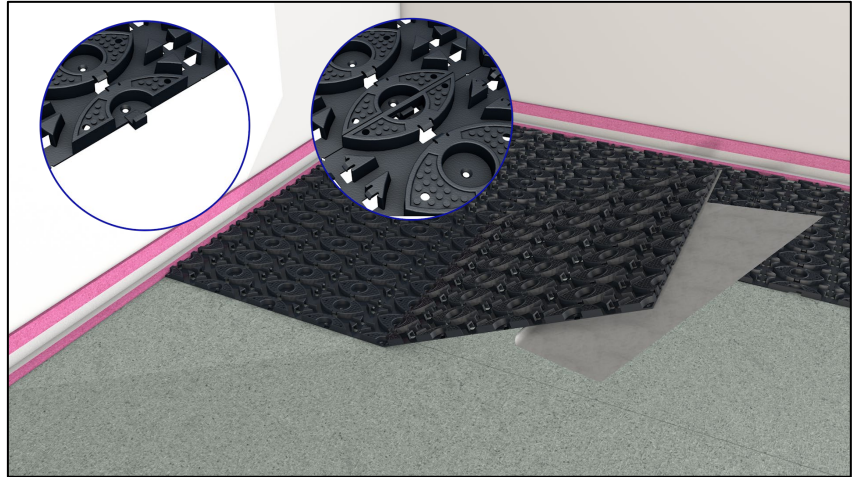

Profix® Clip-Rails supplied within the Profix® Manifold & Highway Pack can be used to create a 'highway' along the edge of a room to facilitate additional pipe runs from and back to the manifold.

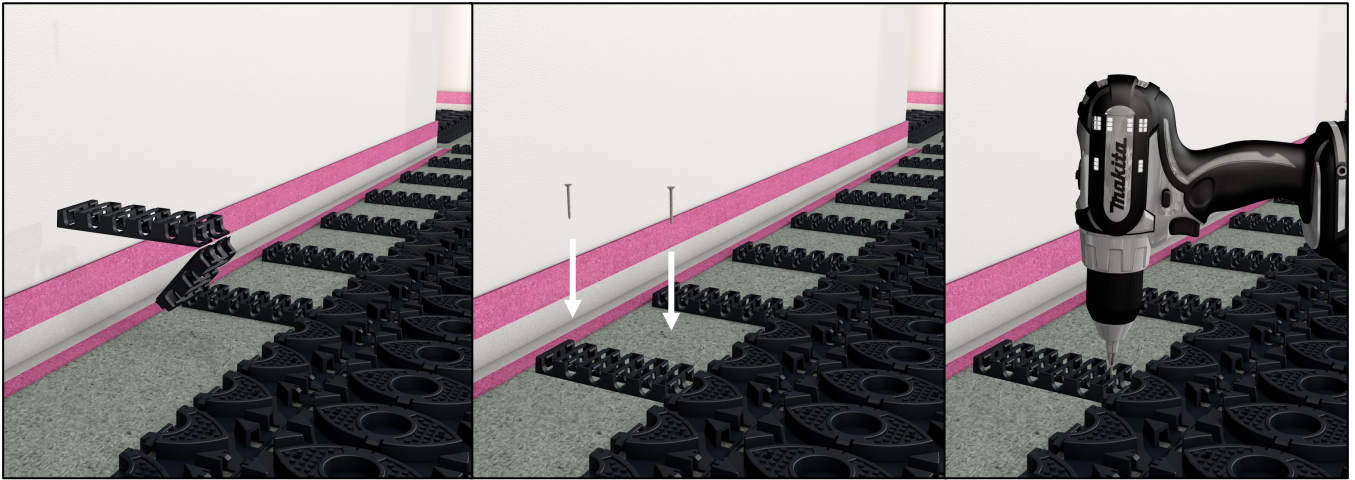

Profix® Clip-Rails can also be used in close proximity to the manifold to secure pipework at close centres prior to transitioning into the Profix® Panels themselves.

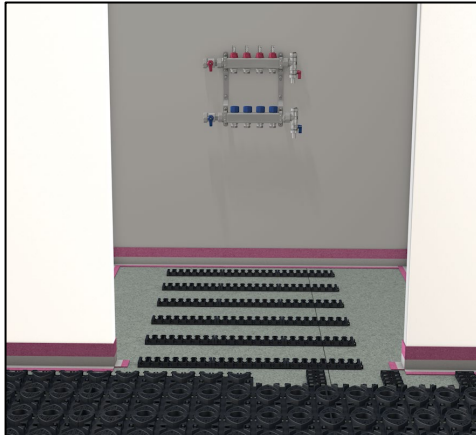

Connect the first pipe run to the manifold.

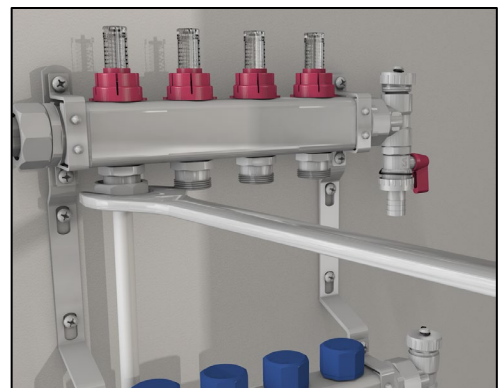

INSTALL THE UFH PIPEWORK

Use a rubber mallet to help secure the pipe into the Profix® Clip-Rails and the Profix® Panels.

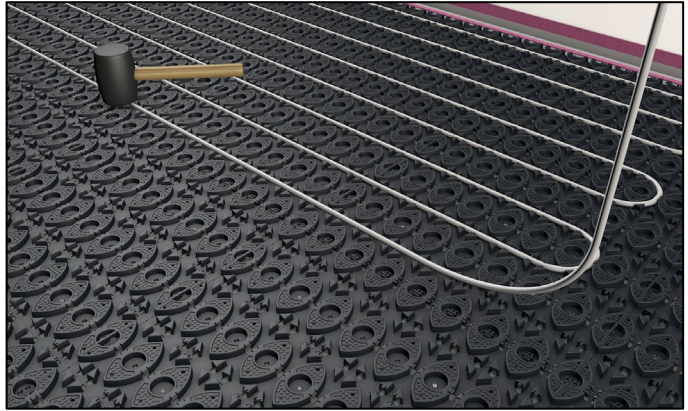
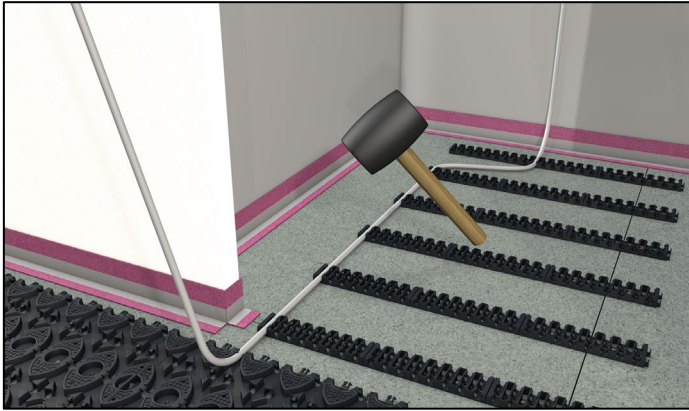

Return the first pipe run to the manifold.

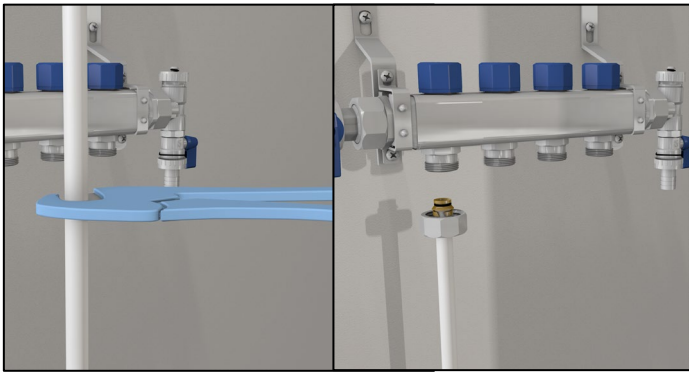

Connect all additional pipe runs to the manifold. Pressure test the system to ensure there are no leaks. Suitable expansion joints should be fitted at all door thresholds.

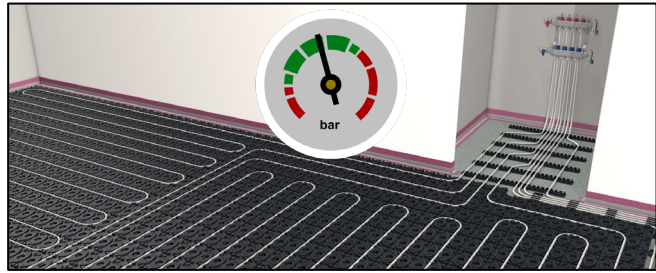

MIX THE PROFIX LEVELLING COMPOUND

Pour 5.0 litres of cold, clean water into a clean container. Add sack contents (25 kg) whilst stirring vigorously until a smooth and lump-free compound is obtained. Use a heavy-duty drill with a suitable levelling compound mixer attachment (minimum 650rpm).



Apply Profix® Levelling Compound to **minimum** 15mm thickness for tiles or engineered wood flooring. Apply Profix® Levelling Compound to **minimum** 18mm thickness for carpet or vinyl flooring.

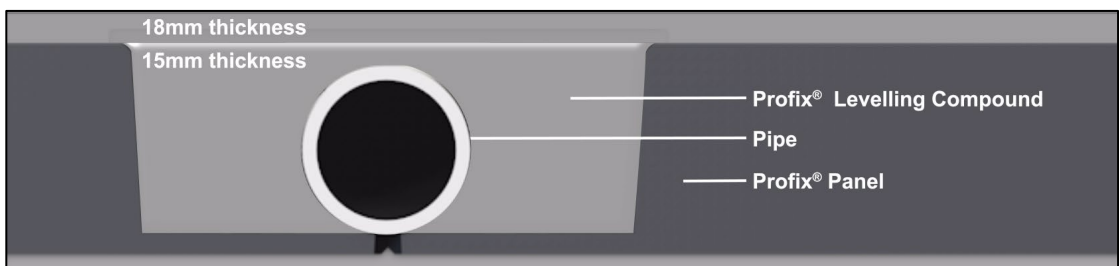

POUR THE PROFIX LEVELLING COMPOUND

Pour the first batch of Profix® Levelling Compound, starting in one corner and working in a continuous line. Repeat with subsequent batches.

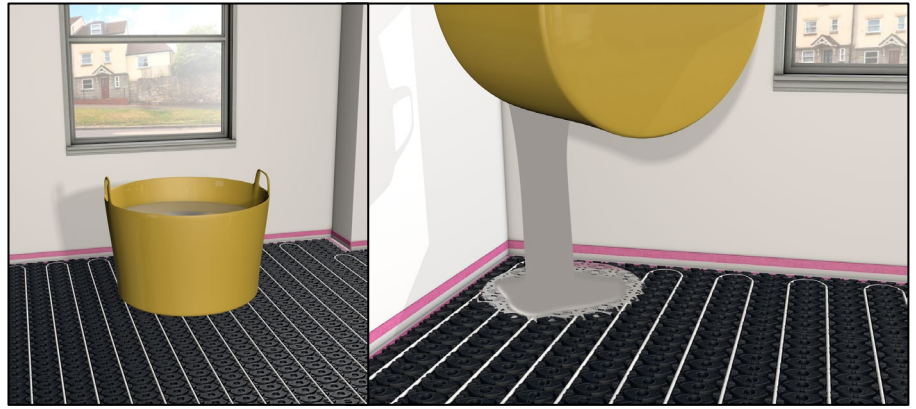

Once sufficient compound has been applied it can be distributed to the required depth using a smoothing trowel or smoothing rake. The surface finish can be improved using a spiked roller.

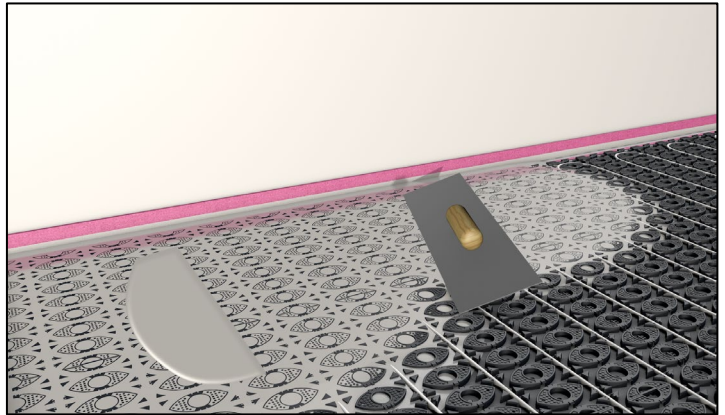

Foot traffic after 4 hours in good drying conditions.

Floor coverings after 24 hours in good drying conditions.

